

Hotline: +84 98 228 3389
<https://locnuoccuulong.com/>

ETL MACHINERY

诚信 / 实力 / 产品质量



ETL MACHINERY



杭州富阳绿创机械设备有限公司
Hangzhou Fuyang ETL Machinery Co.,Ltd.

地址: 浙江省杭州市富阳区新登镇双联村三贤黄家 (邮编: 311404)
电话: 0571-63273816 传真: 0571-63252716
邮箱: etlmachinery@163.com
网址: www.etlmachinery.com

Add: Sanxianhuangjia ,Shuanglian Village, Xindeng Town, Fuyang Dist.
Hangzhou City, Zhejiang China (P.C. 311404)
TEL: +86-571-63273816 Fax: +86-571-63252716
Email: etlmachinery@163.com
Web: www.etlmachinery.com



杭州富阳绿创机械设备有限公司
Hangzhou Fuyang ETL Machinery Co.,Ltd.

公司简介

ABOUT US

杭州富阳绿创机械设备有限公司是一家专业水处理设备生产厂家，公司专业生产不锈钢膜壳，不锈钢精密过滤器，不锈钢袋式过滤器，不锈钢预处理罐，机械过滤器，无菌水箱，紫外线杀菌器等系列产品。

公司由从事水处理行业10年以上经验的专业技术及销售团队组成，经过多年发展已成为集设计，生产，销售于一体的规模化水处理设备的专业生产厂家。公司高度重视引进人才，采用国内外先进的设计及生产加工技术，本着诚信经营、质量第一、严格管理的态度不断完善生产加工工艺、引领行业技术的向前发展。目前公司产品已远销中东、欧美、东南亚等全世界各地区、备受业内企业的青睐。欢迎新老客户光临惠顾。

Hangzhou Fuyang ETL Machinery Co.,Ltd is a professional manufacturer of water treatment equipments,specializing in manufacturing stainless steel RO membrane housing,cartridge filter housing,bag filter housing,pre-filtration tank,mechanical filter housings,water tank & stainless UV sterilizers,and so on.

The factory is established under more than ten years experienced technical and a sales team. After years of developing,the company has become a professional factory specializing in designing,manufacturing and selling liquid filtration equipments. We also fetch in capable workers and adopt advanced technology both from domestic and abroad. The saying "Credit Management, Quality First & Strict Rules" is conducted from top to bottom through the whole team. Until now our products has already stepped a foot in the market Middle East,Europe,America and Asia. Your visit is highly welcomed.



TABLE OF CONTENTS 目录索引

不锈钢膜壳 Ro Membrane Housing

LV1-D40.....	2
LV2-D40.....	3
LV3-D80.....	4

不锈钢精密过滤器 Cartridge Filter Housing

LV1.....	5
LV2.....	6
LV3.....	7
LV4.....	8
LV5.....	9

不锈钢袋式过滤器 Bag Filter Housing

LV1.....	10
LV2.....	11
LV3.....	12
LV4.....	13

不锈钢预处理罐 Pre-filtration Tank

LV1.....	14
LV2.....	15

机械过滤器 Mechanical Filter Housing

LV1.....	16
----------	----

不锈钢无菌水箱 Water Tank

LV1.....	17
----------	----

紫外线杀菌器 SS UV Sterilizer

LV1.....	18
----------	----

不锈钢家用净水机 SS Central Filter

LV1.....	19
LV2.....	19

后记 Remarks.....	21
-----------------	----



LV1-D40不锈钢有缝膜壳

- 1、材质SUS304, SUS316L
- 2、封头材质 ABS
- 3、最大工作压力 300PSI
- 4、表面处理: 机械抛光

LV1-D40

Stainless Steel RO Membrane Housing Seamed

Material: SUS304 SUS316L;
End Cap: ABS Plastic;
Max working pressure 300psi;
Surface Finish: Mechanical Polishing

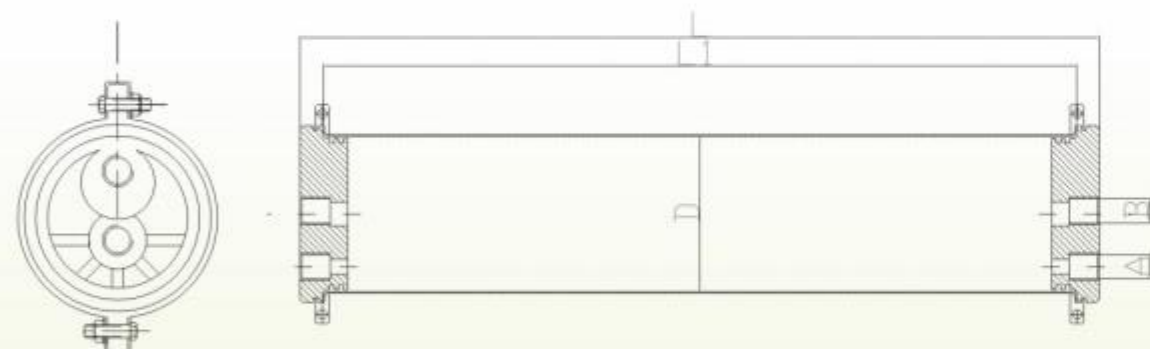

Standard Spec.

Model	L (mm)	L1 (mm)	D (mm)	A (in)	B (out)
LV1-4014	428	368	102	1/2"	1/2"
LV1-4021	605	454	102	1/2"	1/2"
LV1-4040	1088	1028	102	3/4"	1/2"
LV1-4080	2104	2044	102	3/4"	1/2"
LV1-40120	3120	3060	102	3/4"	1/2"
LV1-40160	4136	4076	102	3/4"	1/2"



LV2-D40不锈钢无缝膜壳

- 1、材质SUS304, SUS316L
- 2、封头材质 ABS
- 3、最大工作压力 300PSI
- 4、表面处理: 机械抛光,

LV1-D40

Stainless Steel RO Membrane Housing Seamless

Material: SUS304 SUS316L;
End Cap: ABS Plastic;
Max working pressure 300psi;
Surface Finish: Mechanical Polishing

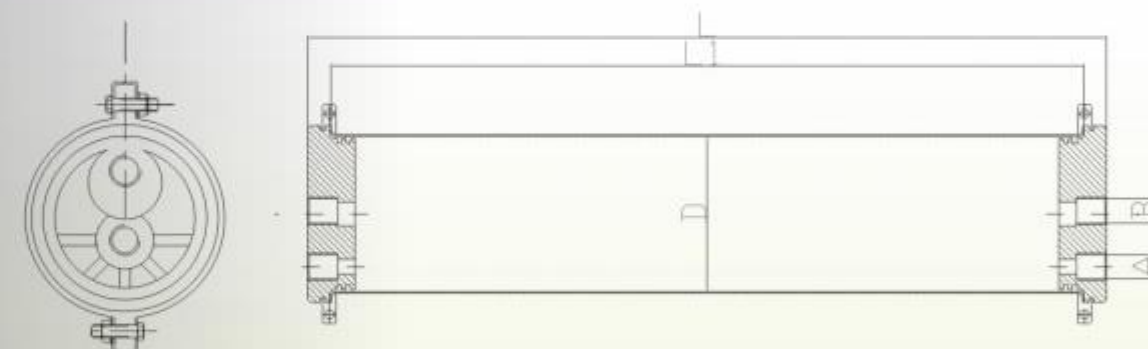

Standard Spec.

Model	L (mm)	L1 (mm)	D (mm)	A (in)	B (out)
LV2-4014	428	368	105	1/2"	1/2"
LV2-4021	605	454	105	1/2"	1/2"
LV2-4040	1088	1028	105	3/4"	1/2"
LV2-4080	2104	2044	105	3/4"	1/2"
LV2-40120	3120	3060	105	3/4"	1/2"
LV2-40160	4136	4076	105	3/4"	1/2"



LV3-D80不锈钢无缝膜壳

- 1、材质SUS304, SUS316L
- 2、封头材质 SS304 316L
- 3、最大工作压力 300PSI
- 4、表面处理: 机械抛光

LV1-D40

Stainless Steel RO Membrane Housing Seamless

Material: SUS304 SUS316L;
End Cap: SS304 316L
Max working pressure 300psi;
Surface Finish: Mechanical Polishing

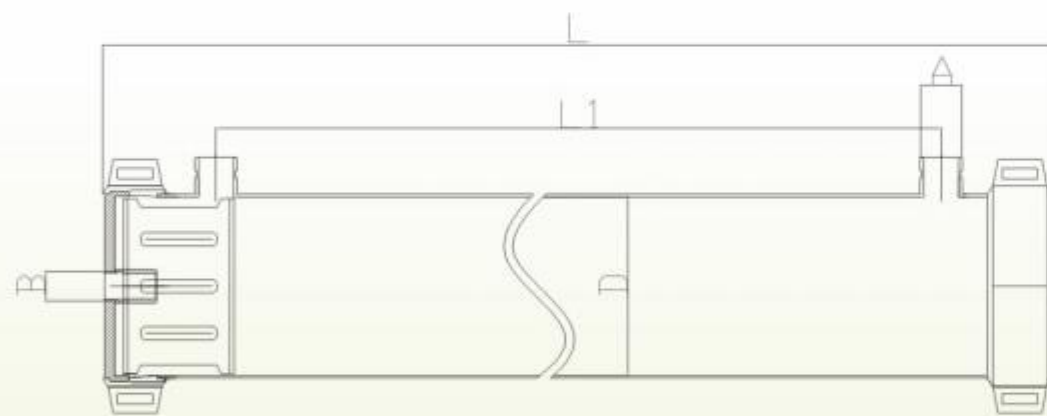

Standard Spec.

Model	L (mm)	L1 (mm)	D (mm)	A (in)	B (out)
LV3-8040	1288	1101	203	1-1/2"	1"
LV3-8080	2304	2117	203	1-1/2"	1"
LV3-80120	3320	3133	203	1-1/2"	1"
LV3-80160	4336	4149	203	1-1/2"	1"
LV3-80200	5352	5165	203	1-1/2"	1"
LV3-80240	6368	6181	203	1-1/2"	1"



LV1-不锈钢精密过滤器

- 1、材质SUS304, SUS316L
- 2、最大工作压力 100Psi
- 3、表面处理: 镜面抛光

LV1-Cartridge Filter Housing

Material: SUS304 SUS316L;
Max working pressure 100psi;
Surface Finish: Mirrr Polishing

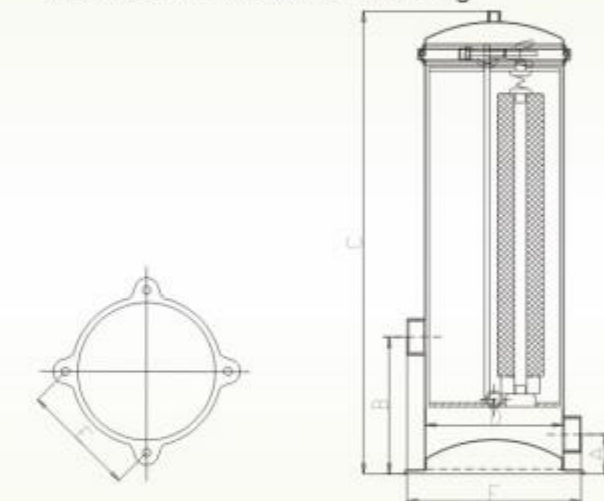

Standard Spec.

Model	A (mm)	B (mm)	C (mm)	D (mm)	E (mm)	F (mm)	In/out	Drain
C3L10	50	190	440	170	136	230	1" -1.5"	1/2"
C3L20	50	190	690	170	136	230	1" -1.5"	1/2"
C3L30	50	190	940	170	136	230	1" -1.5"	1/2"
C3L40	50	190	1190	170	136	270	1" -1.5"	1/2"
C5L10	50	190	440	200	160	270	1"-2"	1/2"
C5L20	50	190	690	200	160	270	1"-2"	1/2"
C5L30	50	190	940	200	160	270	1"-2"	1/2"
C5L40	50	190	1190	200	160	270	1"-2"	1/2"
C7L10	75	350	470	230	190	300	1.5"-2"	1/2"
C7L20	75	350	720	230	190	300	1.5"-2"	1/2"
C7L30	75	350	970	230	190	300	1.5"-2"	1/2"
C7L40	75	350	1220	230	190	300	1.5"-2"	1/2"



LV2-不锈钢精密过滤器

- 1、材质SUS304, SUS316L
- 2、最大工作压力 100Psi
- 3、表面处理: 镜面抛光

LV2-Cartridge Filter Housing

Material: SUS304 SUS316L;
Max working pressure 100psi;
Surface Finish: Mirrr Polishing

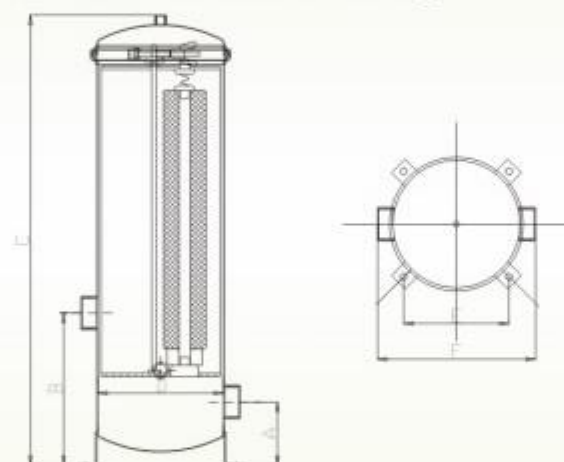

Standard Spec.

Model	A (mm)	B (mm)	C (mm)	D (mm)	E (mm)	F (mm)	In/out	Drain
C3L10	100	240	475	170	150	230	1"-1.5"	1/2"
C3L20	100	240	725	170	150	230	1"-1.5"	1/2"
C3L30	100	240	975	170	150	230	1"-1.5"	1/2"
C3L40	100	240	1225	170	150	230	1"-1.5"	1/2"
C5L10	100	240	475	200	172	275	1"-2"	1/2"
C5L20	100	240	725	200	172	275	1"-2"	1/2"
C5L30	100	240	975	200	172	275	1"-2"	1/2"
C5L40	100	240	1225	200	172	275	1"-2"	1/2"
C7L10	125	350	515	230	192	300	1.5"-2"	1/2"
C7L20	125	350	765	230	192	300	1.5"-2"	1/2"
C7L30	125	350	1015	230	192	300	1.5"-2"	1/2"
C7L40	125	350	1265	230	192	300	1.5"-2"	1/2"



LV3-不锈钢精密过滤器

- 1、材质SUS304, SUS316L
- 2、最大工作压力 150Psi
- 3、表面处理: 镜面抛光

LV3-Cartridge Filter Housing

Material: SUS304 SUS316L;
Max working pressure 150psi;
Surface Finish: Mirrr Polishing

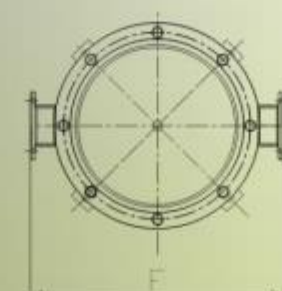
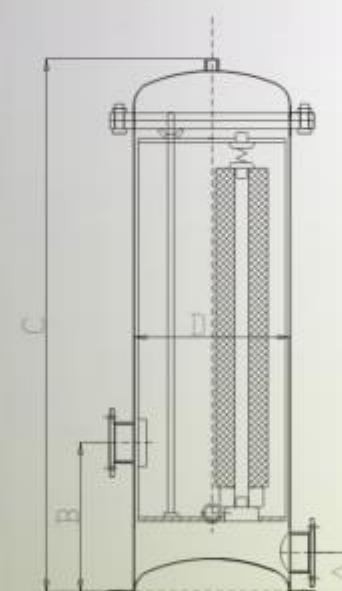

Standard Spec.

Model	A (mm)	B (mm)	C (mm)	D (mm)	F (mm)	In/out	Drain
C5L30	75	180	1060	200	320	1"-2"	1/2"
C5L40	75	180	1350	200	320	1"-2"	1/2"
C7L30	80	350	1110	250	390	1 1/2"-2"	1/2"
C7L40	80	350	1350	250	390	1 1/2"-2"	1/2"
C10L30	150	350	1110	300	440	2"-3"	1/2"
C10L40	150	350	1350	300	440	2"-3"	1/2"
C15L30	150	350	1150	350	490	2"-3"	1/2"
C15L40	150	350	1400	350	490	2"-3"	1/2"
C20L30	150	350	1190	400	560	2"-4"	1/2"
C20L40	150	350	1440	400	560	2"-4"	1/2"
C25L30	150	350	1195	450	610	2"-4"	1/2"
C25L40	150	350	1445	450	610	2"-4"	1/2"
C30L30	150	450	1197	500	660	2"-4"	1/2"
C30L40	150	450	1447	500	660	2"-4"	1/2"
C35L30	150	450	1240	550	730	3"-4"	1/2"
C35L40	150	450	1490	550	730	3"-4"	1/2"
C40L30	150	450	1320	600	760	3"-4"	1/2"
C40L40	150	450	1570	600	760	3"-4"	1/2"
C50L30	150	450	1580	650	830	3"-4"	1/2"
C50L40	150	450	1330	650	830	3"-4"	1/2"
C60L30	150	450	1340	700	880	4"-5"	1/2"
C60L40	150	450	1590	700	880	4"-5"	1/2"



ETL MACHINERY

杭州富阳绿创机械设备有限公司
Hangzhou Fuyang ETL Machinery Co., Ltd.
地址: 浙江省杭州市富阳区新登镇双联村三进路 (邮编: 311404)
Add: Sanshanhuangjie, Shuanglian Village, Kindeng Town, Fuyang
Dist: Hangzhou City, Zhejiang China (P. C. 311404)
电话(Tel): 0571-63273816 传真(Fax): 0571-63252716
邮箱(Email): etlmachinery@163.com
网站(Web): www.etlmachinery.com



LV4-不锈钢精密过滤器

- 1、材质SUS304, SUS316L
- 2、最大工作压力 150Psi
- 3、表面处理: 镜面抛光

LV4-Cartridge Filter Housing

Material: SUS304 SUS316L;
Max working pressure 150psi;
Surface Finish: Mirrr Polishing

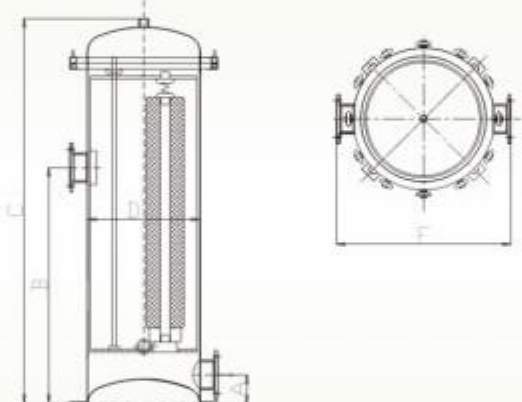

Standard Spec.

Model	A (mm)	B (mm)	C (mm)	D (mm)	F (mm)	In/out	Drain
C5L30	75	180	1065	200	320	1" -2"	1/2"
C5L40	75	180	1355	200	320	1" -2"	1/2"
C7L30	80	350	1115	250	390	1 1/2"-2"	1/2"
C7L40	80	350	1355	250	390	1 1/2"-2"	1/2"
C10L30	150	350	1115	300	440	2"-3"	1/2"
C10L40	150	350	1355	300	440	2"-3"	1/2"
C15L30	150	350	1155	350	490	2"-3"	1/2"
C15L40	150	350	1405	350	490	2"-3"	1/2"
C20L30	150	350	1195	400	560	2"-4"	1/2"
C20L40	150	350	1445	400	560	2"-4"	1/2"
C25L30	150	350	1200	450	610	2"-4"	1/2"
C25L40	150	350	1450	450	610	2"-4"	1/2"
C30L30	150	450	1202	500	660	2"-4"	1/2"
C30L40	150	450	1452	500	660	2"-4"	1/2"



LV5-不锈钢精密过滤器

- 1、材质SUS304, SUS316L
- 2、最大工作压力 150Psi
- 3、表面处理: 镜面抛光

LV5-Cartridge Filter Housing

Material: SUS304 SUS316L;
Max working pressure 150psi;
Surface Finish: Mirrr Polishing

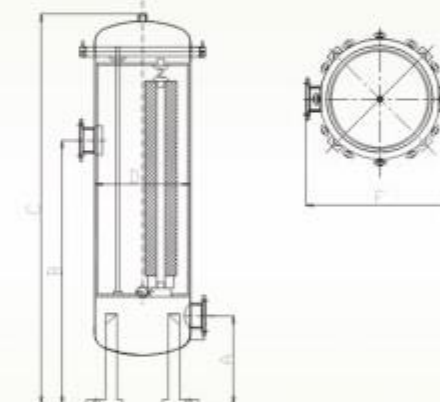

Standard Spec.

Model	A (mm)	B (mm)	C (mm)	D (mm)	F (mm)	In/out	Drain
C5L30	250	600	1250	200	340	1" -2"	1/2"
C5L40	250	700	1500	200	340	1" -2"	1/2"
C7L30	300	700	1300	250	390	1 1/2"-2"	1/2"
C7L40	300	800	1550	250	390	1 1/2"-2"	1/2"
C10L30	360	700	1380	300	440	2"-3"	1/2"
C10L40	360	900	1620	300	440	2"-3"	1/2"
C15L30	380	800	1420	350	530	2"-3"	1/2"
C15L40	380	900	1700	350	530	2"-3"	1/2"
C20L30	400	800	1460	400	560	2"-4"	1/2"
C20L40	400	900	1700	400	560	2"-4"	1/2"
C25L30	420	800	1500	450	590	2"-4"	1/2"
C25L40	420	900	1730	450	590	2"-4"	1/2"
C30L30	460	800	1530	500	630	2"-4"	1/2"
C30L40	460	1000	1770	500	630	2"-4"	1/2"



LV1-不锈钢袋式过滤器

- 1、材质SUS304, SUS316L
- 2、最大工作压力 100Psi
- 3、表面处理: 镜面抛光

LV1-Bag Filter Housing

Material: SUS304 SUS316L;
Max working pressure 100psi;
Surface Finish: Mirrr Polishing

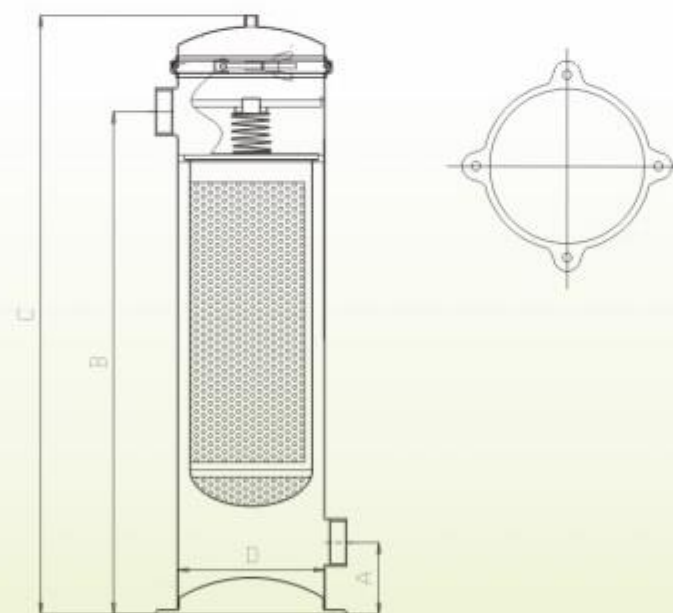

Standard Spec.

Model	A (mm)	B (mm)	C (mm)	D (mm)	In/out	
LV1-17	50	535	690	200	2"	1号
LV1-32	50	885	1040	200	2"	2号



LV2-不锈钢袋式过滤器

- 1、材质SUS304, SUS316L
- 2、最大工作压力 100Psi
- 3、表面处理: 镜面抛光

LV2-Bag Filter Housing

Material: SUS304 SUS316L;
Max working pressure 100psi;
Surface Finish: Mirrr Polishing

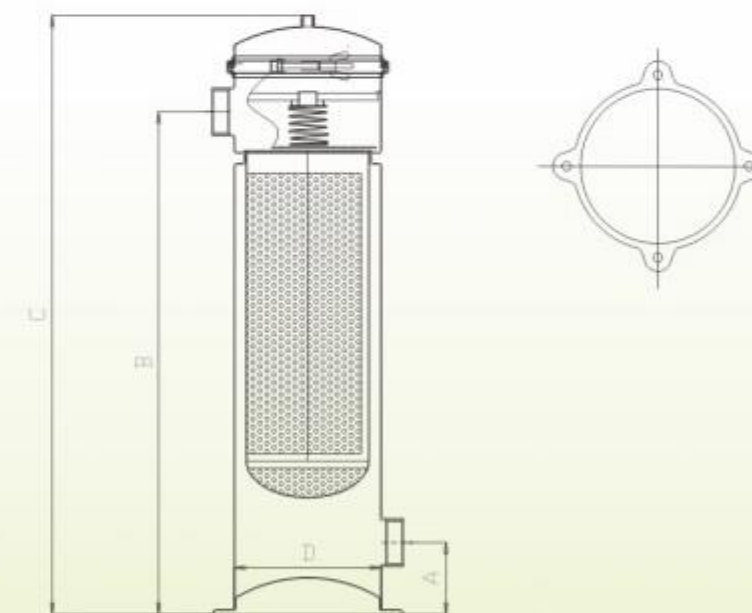

Standard Spec.

Model	A (mm)	B (mm)	C (mm)	D (mm)	In/out	
LV2-17	50	530	680	200	2"	1号
LV2-32	50	880	1030	200	2"	2号



LV3-不锈钢袋式过滤器
1、材质SUS304, SUS316L
2、最大工作压力 150Psi
3、表面处理: 镜面抛光

LV3-Bag Filter Housing

Material: SUS304 SUS316L;
Max working pressure 150psi;
Surface Finish: Mirrr Polishing

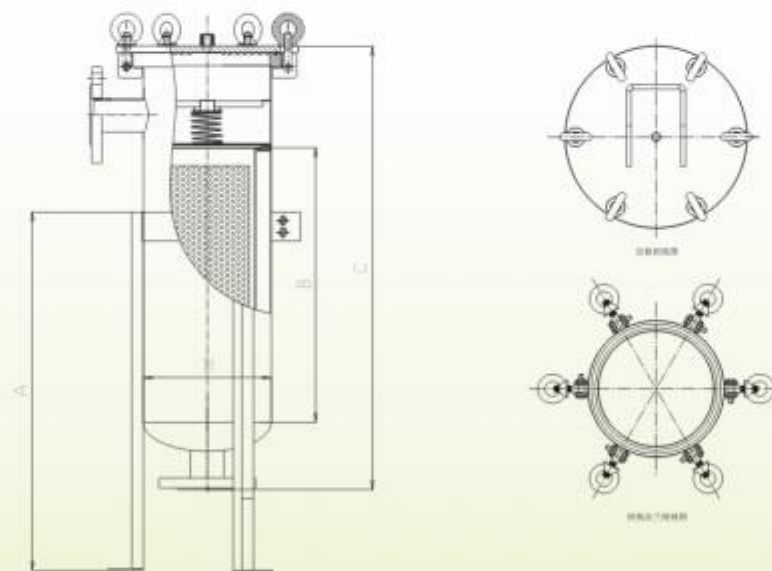

Standard Spec.

Model	A (mm)	B (mm)	C (mm)	D (mm)	In/out	
LV3-17	510	380	720	200	1"-3"	1号
LV3-32	860	720	1070	200	1"-3"	2号



LV4-不锈钢袋式过滤器
1、材质SUS304, SUS316L
2、最大工作压力 150Psi
3、表面处理: 镜面抛光

LV4-Bag Filter Housing

Material: SUS304 SUS316L;
Max working pressure 150psi;
Surface Finish: Mirrr Polishing

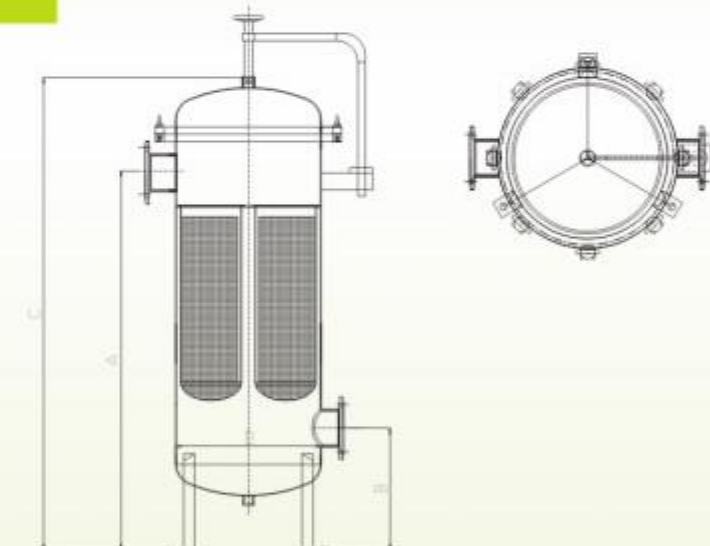

Standard Spec.

Model	A (mm)	B (mm)	C (mm)	D (mm)	In/out	Drain
LV4-2	1255	300	1555	400	3"	1/2"
LV4-3	1330	300	1610	500	3"-4"	1/2"
LV4-4	1430	400	1780	550	3"-4"	1/2"
LV4-5	1445	400	1830	650	3"-5"	1/2"
LV4-6	1460	500	1970	700	3"-5"	1/2"
LV4-8	1590	500	2000	750	5"-6"	1/2"
LV4-9	1610	500	2030	800	6"-8"	1/2"



LV1-不锈钢预处理罐

- 1、材质SUS304, SUS316L
- 2、最大工作压力 100Psi
- 3、表面处理: 镜面抛光

LV1- Prefiltration Tank

Material: SUS304 SUS316L;
Max working pressure 100psi;
Surface Finish: Mirrr Polishing

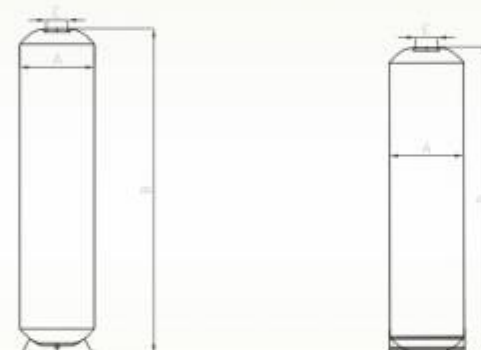

Standard Spec.

Model	A (mm)	B (mm)	E (mm)
0844	200	1100	2-1/2"
1030	250	750	2-1/2"
1037	250	950	2-1/2"
1042	250	1050	2-1/2"
1043	250	1100	2-1/2"
1052	250	1320	2-1/2"
1054	250	1370	2-1/2"
1254	300	1370	2-1/2"
1354	330	1370	2-1/2"
1465	350	1650	2-1/2"
1665	400	1650	2-1/2"
1865	450	1650	4"
2065	500	1650	4"



LV2-不锈钢预处理罐

- 1、材质SUS304, SUS316L
- 2、最大工作压力 100Psi
- 3、表面处理: 镜面抛光

LV2- Prefiltration Tank

Material: SUS304 SUS316L;
Max working pressure 100psi;
Surface Finish: Mirrr Polishing

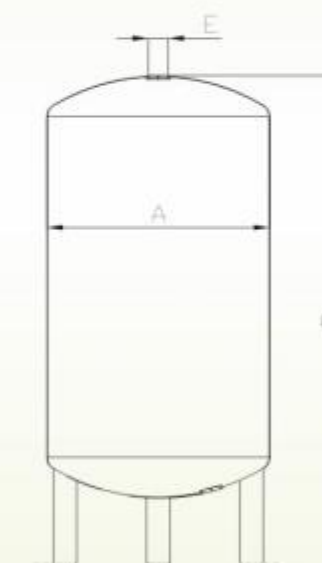

Standard Spec.

Model	A (mm)	B (mm)	E (mm)
2265	550	1650	4"
2472	600	1850	4"
3072	750	1850	4"
3272	800	1850	4"
3672	900	1850	4"
4272	1000	1850	4"
4872	1200	1850	4"



LV1-不锈钢机械过滤器

- 1、材质SUS304, SUS316L Q235
- 2、最大工作压力 100Psi
- 3、表面处理: 镜面抛光

LV1- Mechanical Filter Housing

Material: SUS304 SUS316L;Q235
Max working pressure 100psi;
Surface Finish: Mirrr Polishing

Standard Spec.

Model	A (mm)	B (mm)	C (mm)	F (mm)	In/out	Vent
300x1200	300	1200	1800	300	1"	3/4"
400x1500	400	1500	2150	300	1"	3/4"
500x1500	500	1500	2230	300	1-1/4"	1"
600x1500	600	1500	2290	300	1-1/4"	1"
700x1500	700	1500	2340	300	1-1/2"	1"
800x1500	800	1500	2390	300	1-1/2"	1"
900x1500	900	1500	2600	300	1-1/2"	1"
1000x1500	1000	1500	2750	400	1-1/2"	1"
1100x1500	1100	1500	2800	400	2"	1-1/4"
1200x1500	1200	1500	2850	400	2"	1-1/4"
1400x1500	1400	1500	2950	400	2"	1-1/4"
1500x1800	1500	1800	3360	400	2"	1-1/4"
1600x1800	1600	1800	3500	400	2-1/2"	1-1/2"
1800x1800	1800	1800	3610	400	2-1/2"	1-1/2"
2000x1800	2000	1800	3710	400	3"	1-1/2"
2200x1800	2200	1800	3810	400	3"	1-1/2"
2500x2000	2500	2000	3860	400	3"	1-1/2"

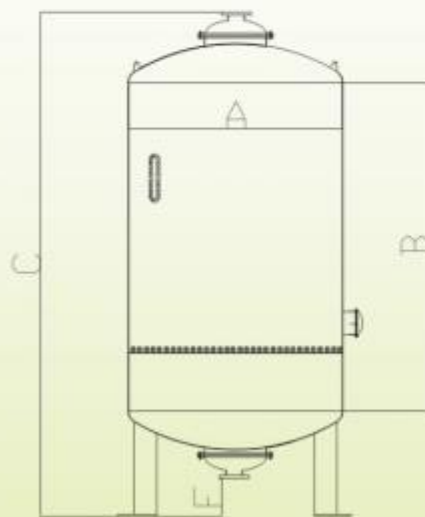

LV1-不锈钢水箱

- 1、材质SUS304, SUS316L
- 2、最大工作压力 100Psi
- 3、表面处理: 镜面抛光

LV1- Water Tank

Material: SUS304 SUS316L;
Max working pressure 100psi;
Surface Finish: Mirrr Polishing

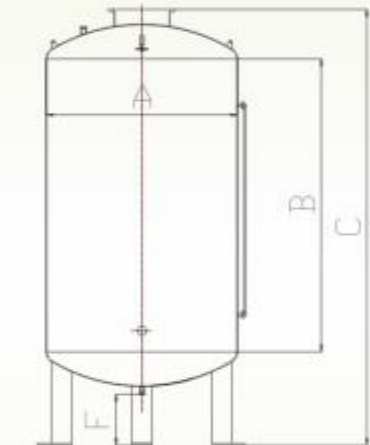

Standard Spec.

Model	A (mm)	B (mm)	C (mm)	F (mm)	In/out	Vent
0.3T	550	1220	1830	250	3/4"	3/4"
0.5T	700	1220	1910	250	3/4"	3/4"
1T	1000	1220	2110	300	1"	3/4"
2T	1300	1500	2540	300	1"	3/4"
3T	1600	1500	2690	300	1-1/2"	3/4"
4T	1600	2000	3190	300	1-1/2"	3/4"
5T	1800	2000	3290	300	1-1/2"	3/4"
6T	1900	2000	3390	350	1-1/2"	3/4"
8T	2000	2500	3940	350	2"	3/4"
10T	2200	2400	3940	350	2"	3/4"



ETL MACHINERY

杭州富阳绿创机械设备有限公司
Hangzhou Fuyang ETL Machinery Co., Ltd.
地址: 浙江省杭州市富阳区新登镇双联村三进黄家 (邮编: 311404)
Add: Sanshanhuangjia, Shuanglian Village, Kindeng Town, Fuyang
Dist: Hangzhou City, Zhejiang China (P. C. 311404)
电话(Tel): 0571-63273816 传真(Fax): 0571-63252716
邮箱(Email): etlmachinery@163.com
网站(Web): www.etlmachinery.com



LV1-紫外线杀菌器

- 1、材质SUS304, SUS316L
- 2、最大工作压力 100Psi
- 3、表面处理: 镜面抛光

LV1- UV Sterilizer

Material: SUS304 SUS316L;
Max working pressure 100psi;
Surface Finish: Mirrr Polishing

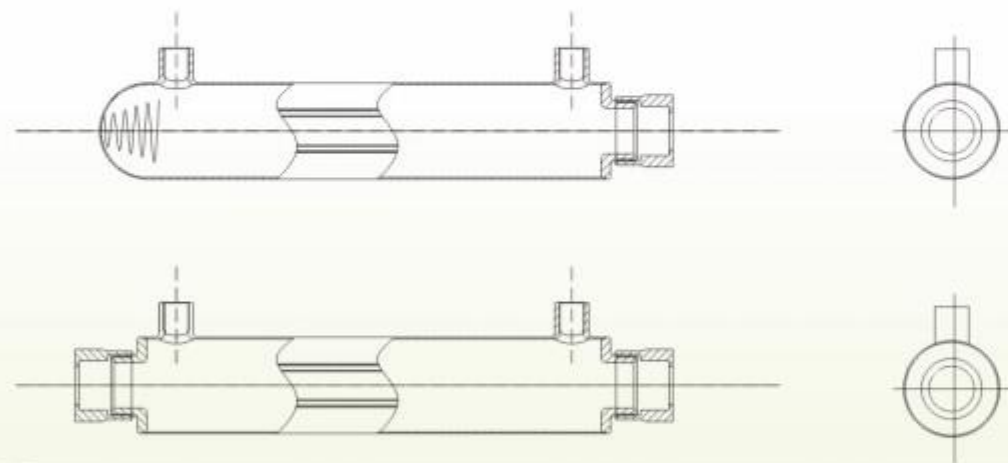

Standard Spec.

Model	Power	L/H	GPM	Length	Diamter	In/out
L1-4W	4W	55	0.3	200	50.8	1/4"
L1-6W	6W	120	0.5	255	50.8	1/4"
L1-12W	12W	230	1	325	50.8	1/4"
L1-16W	16W	480	2	375	63.5	1/2"
L1-25W	25W	1300	6	595	63.5	1/2"
L1-30W	30W	1800	8	910	63.5	3/4"
L1-35W	35W	2270	10	950	63.5	3/4"
L1-55W	55W	2725	12	950	63.5	3/4"

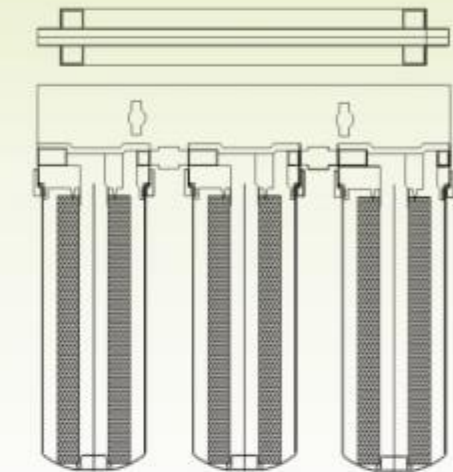

L1 家用净水器Water Purifier

特点: 7级深度净化直接饮用

- 1. PP 采用外5内1PP棉过滤有效去除水中杂质, 如泥沙, 铁锈, 红虫, 颗粒, 絮状物, 悬浮物和胶体等。
- 2. Carbon 进口活性炭, 有效去除水中异味, 农药化肥, 部分余氯等。
- 3. KDF 美国进口KDF, 有效去除水中对人体不利成分如重金属, 余氯, 控制细菌生长, 去除硫化氢, 减少矿物质结垢。
- 4. Defluoriation 高效去氟球, 彻底清除病菌, 顽固性余氯等小污染物。
- 5. Mineralization 矿化球可以将对人体有益的, 锌, 锂, 碘, 硒等二十多种微量元素均布在水中, 对人体更为有益。
- 6. Coconut carbon 进口椰壳炭, 可以进一步去除水中异味, 改善水质, 防止二次污染。
- 7. Magnetizing 强磁处理, 改变水分子结构, 增加水的含氧量及活性, 饮用后能自动调节人体酸碱平衡, 耐高温120度, 使用寿命可达10年以上。

L2 家用净水器Water Purifier

特点: 9级深度净化直接饮用

- 1. PP 采用外5内1PP棉过滤有效去除水中杂质, 如泥沙, 铁锈, 红虫, 颗粒, 絮状物, 悬浮物和胶体等。
- 2. UF 采用进口中空纤维超滤膜, 过滤精度达到0.01um.能有效过滤水中细菌, 微生物等。
- 3. KDF 美国进口KDF, 有效去除水中对人体不利成分如重金属, 余氯, 控制细菌生长, 去除硫化氢, 减少矿物质结垢。
- 4. Defluoriation 高效去氟球, 彻底清除病菌, 顽固性余氯等小污染物。
- 5. Mineralization 矿化球可以将对人体有益的, 锌, 锂, 碘, 硒等二十多种微量元素均布在水中, 对人体更为有益。
- 6. Coconut carbon 进口椰壳炭, 可以进一步去除水中异味, 改善水质, 防止二次污染。
- 7. Medical Stone 麦饭石具有多孔性, 吸附能力极强, 还能融出矿物质, 使水中溶氧量丰富, 并调节水中矿物质平衡。
- 8. Carbonation. 采用进口精密碳纤维, 进一步净化水质, 改善饮用水口感。
- 9. Magnetizing 强磁处理, 改变水分子结构, 增加水的含氧量及活性, 饮用后能自动调节人体酸碱平衡, 耐高温120度, 使用寿命可达10年以上。



REMARK



Coup Ling 卡套

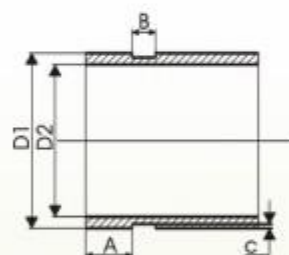
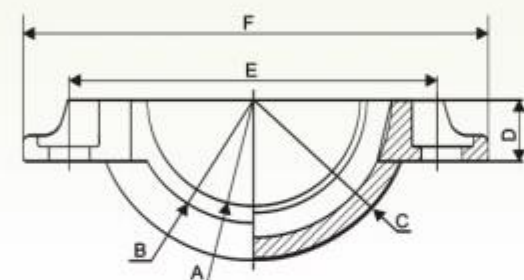

Standard Spec.

Size	D1	D2	A	B	C
3/4"	φ26.7	φ20.96	15.88	7.95	1.42
1"	φ33.4	φ26.64	15.88	7.95	1.60
1-1/4"	φ42.2	φ35.08	15.88	7.95	1.60
1-1/2"	φ48.3	φ40.94	15.88	7.95	1.60
2"	φ60.3	φ52.48	15.88	7.95	1.60
2-1/2"	φ73.0	φ63.44	15.88	7.95	1.98
3"	φ88.9	φ79.34	15.88	7.95	1.98
4"	φ114.3	φ103.98	15.88	9.53	2.11
5"	φ141.3	φ130.98	15.88	9.53	2.13
6"	φ168.3	φ157.18	15.88	9.53	2.16
8"	φ219.1	φ207.00	19.05	11.13	2.34

Standard Spec.

Size	A	B	C	D	E	F	G
3/4"	φ24.3	φ33.7	φ51.7	16	64.7	89.3	44
1"	φ30.7	φ40.1	φ58.1	16	71.1	96.1	45
1-1/4"	φ39.5	φ48.9	φ66.9	16	79.9	104.9	45
1-1/2"	φ45.5	φ54.9	φ72.9	16	85.9	110.9	45
2"	φ57.6	φ67.0	φ85.0	16	98.0	123.0	46
2-1/2"	φ70.0	φ78.0	φ98.0	20	112.0	137.0	48
3"	φ85.4	φ95.0	φ115.4	20	134.0	163.0	48
4"	φ110.4	φ120.0	φ143.4	24	160.0	189.0	48
5"	φ137.4	φ148.4	φ170.44	26	186.0	219.0	48
6"	φ164.4	φ174.4	φ197.4	28	219.0	254.0	48

REMARK section with horizontal dashed lines for notes.